

TRANSPORTATION COMMITTEE MEETING

July 13, 2023

The Transportation Committee of the Henry County Board met in the office of the County Engineer on July 13, 2023. Member Rex Kiser called the meeting to order at 3:00 p.m. with the following members:

Rex Kiser, Chairman ó Present
Dave Dobbels, Member ó Present
Natalie Hendryx, Member ó Present
Dale Stiles, Member ó Present
Tim Wells, Member ó Present
Scott Stephenson, County Engineer

D. Dobbels moved to approve the agenda. N. Hendryx seconded. Motion carried.

No comment during public comment.

Minutes have been approved from the last meeting by signature.

The Transportation Committee members approved the bills by signature since the last meeting.

County Engineer Report:

S. Stephenson informed the committee of the following:

- Portions of CH 2 & CH 4 have been milled, paved, and striped. This completes the County's major paving for the year.
- City of Geneseo paving is complete.
- Started seal coating township roads.
- In August we are scheduled to pave Village of Atkinson.
- We have made 3 batches of patch mix.
- Dunn Company has started the annual township road grinding project.
- Monday the new Bobcat Skid Steer was delivered.
- Today the new sign truck was delivered.

Old Business

Road Use Agreement for Bishop Hill 2 Wind Farm will go in front of the County Board next Thursday.

New Business

On Tuesday, June 20, 2023, at 9:00 am the Cornwall Bridge Letting was held in the office of the County Engineer. S. Stephenson distributed and recommended the committee award to the lowest bidder. The funding will be 80% State, 10% County, and 10% Cornwall Township. T. Wells moved to recommend the Board award Curnyn Construction the Cornwall Bridge project for \$597,213.00. D. Stiles seconded..

Roll Call Vote: 5 ó Aye ö R. Kiser, D. Dobbels, T. Wells, D. Stiles, and N. Hendryx.
Motion carried.

S. Stephenson presented the Road Use Agreement for Bishop Hill 1 Wind Farm. Discussion followed. N. Hendryx moved to recommend the Board layover the agreement for review for 30 days. D. Stiles seconded.

Roll Call Vote: 5 ðAyeö R. Kiser, D. Dobbels, T. Wells, D. Stiles, and N. Hendryx.
Motion carried.

Upcoming Meeting:

- Thursday, August 10, 2023 at 3:00 p.m. ó Committee Meeting ó Office of the County Engineer

D. Stiles moved to adjourn the meeting at 3:37 pm. D. Dobbels seconded. Motion carried.

Rex Kiser, Chairman

Dave Dobbels, Member

Natalie Hendryx, Member

Dale Stiles, Member

Tim Wells, Member

Respectfully submitted,
Kristin Helg
Office Manager



**HENRY COUNTY HIGHWAY DEPARTMENT
TABULATION OF BIDS
CORNWALL ROAD DISTRICT SECTION 17-09130-00-BR**

LETTING DATE: June 20, 2023
LETTING TIME: 9:00 A.M.

| ITEM NO. | PAY ITEM | UNITS | QUANTITY | Curmyn Construction Co. Geneseo, IL | | Brandt Construction Co. Milan, IL | | ESTIMATE | |
|-------------------|-------------------------------|-------|---------------|--|---------------------|--------------------------------------|---------------------|-------------|--------------|
| | | | | Bid Bond | Yes | Bid Bond | Yes | Bid Bond | Bid Bond |
| | | | | | | | | | |
| 20200100 | Earth Excavation | CY | 232.0 | \$14.00 | \$3,248.00 | \$20.00 | \$4,640.00 | \$27.00 | \$6,264.00 |
| 20400800 | Furnished Excavation | CY | 1,986.0 | \$25.00 | \$49,650.00 | \$35.00 | \$69,510.00 | \$30.00 | \$59,580.00 |
| 25000200 | Seeding, Cl 2 | Acre | 0.75 | \$3,000.00 | \$2,250.00 | \$4,475.00 | \$3,356.25 | \$6,000.00 | \$4,500.00 |
| 25000400 | Nitrogen Fert Nutr | LB | 68.0 | \$3.00 | \$204.00 | \$1.10 | \$74.80 | \$5.00 | \$340.00 |
| 25000500 | Phosphorous Fert Nutr | LB | 68.0 | \$3.00 | \$204.00 | \$1.10 | \$74.80 | \$5.00 | \$340.00 |
| 25000600 | Potassium Fert Nutr | LB | 68.0 | \$3.00 | \$204.00 | \$1.10 | \$74.80 | \$5.00 | \$340.00 |
| 25100115 | Mulch Method 2 | Acre | 0.75 | \$3,000.00 | \$2,250.00 | \$4,475.00 | \$3,356.25 | \$4,900.00 | \$3,675.00 |
| 28000250 | Temp Eros Contr Seed | LB | 75.0 | \$2.00 | \$150.00 | \$2.25 | \$168.75 | \$5.00 | \$375.00 |
| 28000305 | Temp Ditch Checks | FT | 96.0 | \$15.00 | \$1,440.00 | \$17.00 | \$1,632.00 | \$15.00 | \$1,440.00 |
| 28000400 | Perimeter Eros Bar | FT | 1,456.0 | \$3.00 | \$4,368.00 | \$3.35 | \$4,877.60 | \$3.50 | \$5,096.00 |
| 28100807 | Stone Dump Rip CL A4 | Ton | 385.0 | \$70.00 | \$26,950.00 | \$70.00 | \$26,950.00 | \$25.00 | \$9,625.00 |
| 40200800 | Agg Surf Cse B | Ton | 580.0 | \$36.00 | \$20,880.00 | \$35.00 | \$20,300.00 | \$26.00 | \$15,080.00 |
| 50100100 | Rem Exist Struct | Each | 1.0 | \$27,000.00 | \$27,000.00 | \$30,000.00 | \$30,000.00 | \$50,000.00 | \$50,000.00 |
| 50105220 | Pipe Culvert Remov | FT | 56.0 | \$9.00 | \$504.00 | \$16.00 | \$896.00 | \$15.00 | \$840.00 |
| 50200100 | Structure Excavation | CY | 50.2 | \$35.00 | \$1,757.00 | \$20.00 | \$1,004.00 | \$45.00 | \$2,259.00 |
| 50300225 | Conc Struct | CY | 26.2 | \$975.00 | \$25,545.00 | \$1,860.00 | \$48,732.00 | \$1,000.00 | \$26,200.00 |
| 50300280 | Concrete Encasement | CY | 6.5 | \$970.00 | \$6,305.00 | \$1,300.00 | \$8,450.00 | \$750.00 | \$4,875.00 |
| 50400605 | PP Conc DK BM 33 DP | SF | 2,110.0 | \$112.00 | \$236,320.00 | \$122.00 | \$257,420.00 | \$100.00 | \$211,000.00 |
| 50800205 | Reinf. Bars, Epoxy Coated | LB | 3,620.0 | \$2.50 | \$9,050.00 | \$3.75 | \$13,575.00 | \$5.00 | \$18,100.00 |
| 50900205 | Steel Railing, Ty S1 | FT | 176.0 | \$180.00 | \$31,680.00 | \$195.00 | \$34,320.00 | \$180.00 | \$31,680.00 |
| 51201800 | Furn Steel Piles HP 14x73 | FT | 875.0 | \$98.00 | \$85,750.00 | \$80.00 | \$70,000.00 | \$110.00 | \$96,250.00 |
| 51202305 | Driving Piles | FT | 875.0 | \$2.00 | \$1,750.00 | \$1.00 | \$875.00 | \$1.00 | \$875.00 |
| 51203800 | Test Pile St HP 14x73 | Each | 2.0 | \$11,000.00 | \$22,000.00 | \$10,000.00 | \$20,000.00 | \$10,000.00 | \$20,000.00 |
| 51204650 | Pile Shoes | Each | 12.0 | \$350.00 | \$4,200.00 | \$200.00 | \$2,400.00 | \$200.00 | \$2,400.00 |
| 51500100 | Name Plates | Each | 1.0 | \$450.00 | \$450.00 | \$800.00 | \$800.00 | \$700.00 | \$700.00 |
| 54262724 | Metal Flared End Sections 24" | Each | 8.0 | \$250.00 | \$2,000.00 | \$759.98 | \$6,079.84 | \$350.00 | \$2,800.00 |
| 542C0229 | P Cul CL Cl 24 | FT | 83.0 | \$98.00 | \$8,134.00 | \$80.00 | \$6,640.00 | \$120.00 | \$9,960.00 |
| 59300100 | Contr Low-Streng Matl | CY | 57.0 | \$250.00 | \$14,250.00 | \$215.00 | \$12,255.00 | \$190.00 | \$10,830.00 |
| 72501000 | Terminal Marker- DA | Each | 4.0 | \$55.00 | \$220.00 | \$55.00 | \$220.00 | \$40.00 | \$160.00 |
| X7011800 | Traf Cont-Prot BLR 21 | Each | 1.0 | \$2,500.00 | \$2,500.00 | \$5,500.00 | \$5,500.00 | \$2,500.00 | \$2,500.00 |
| Z0013798 | Construction Layout | LS | 1.0 | \$6,000.00 | \$6,000.00 | \$4,500.00 | \$4,500.00 | \$6,000.00 | \$6,000.00 |
| Total Bid: | | | | | \$597,213.00 | | \$658,682.09 | | |
| | | | As Read: | | | | | | |
| | | | As Corrected: | | | | | | |

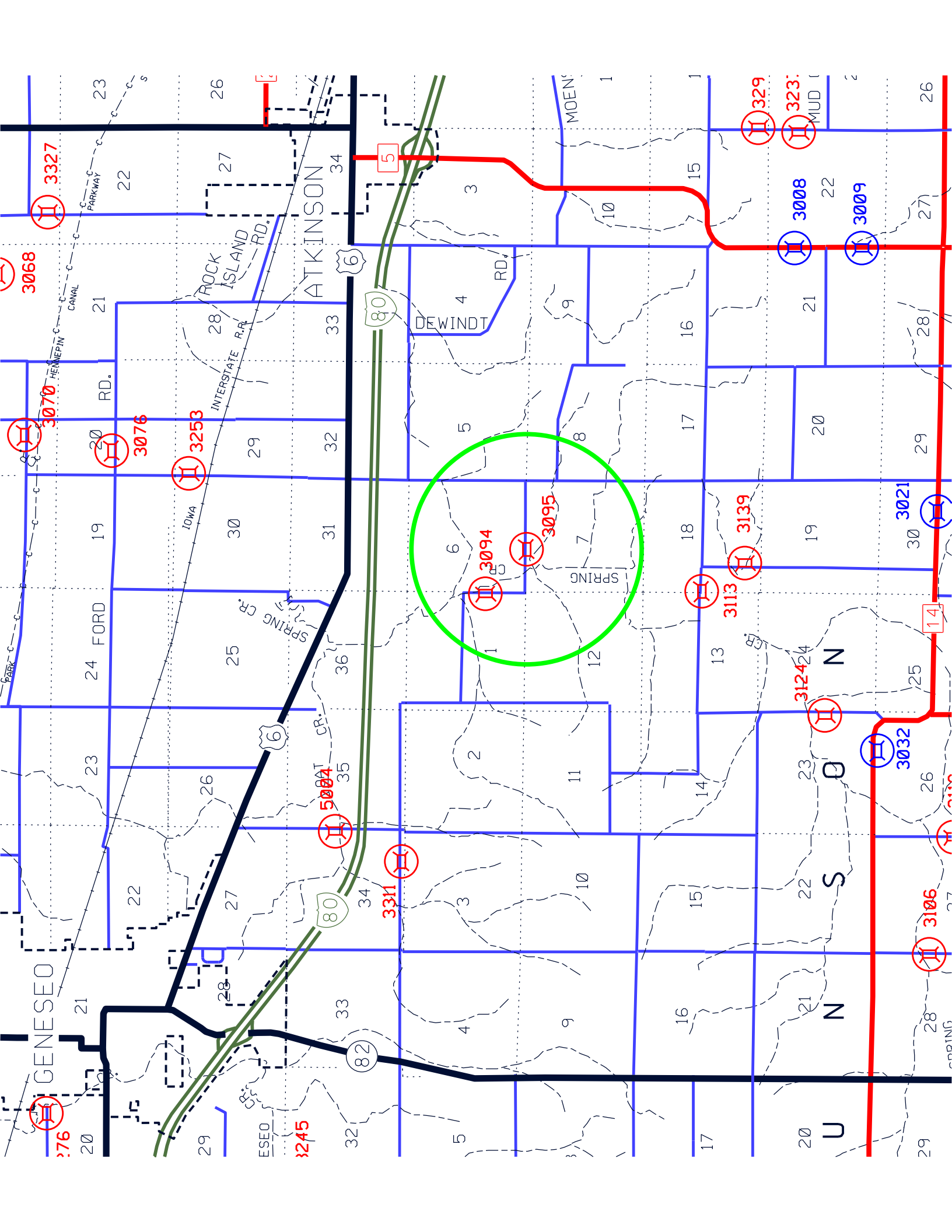

3068

3070

3076

3253

5004

3311

3094

3095

3113

3139

3124

3032

3106

3008

3009

329

323

376

3245

3327

3068

3070

3076

3253

5004

3311

3094

3095

3113

3139

3124

3032

3106

3008

3009

329

323

376

3245

3327

3068

3070

3076

3253

5004

3311

3094

3095

3113

3139

3124

3032

3106

3008

3009

329

323

376

3245

3327

3068

3070

3076

3253

5004

3311

3094

3095

3113

3139

3124

3032

3106

3008

3009

329

323

376

3245

3327

3068

3070

3076

3253

5004

3311

3094

3095

3113

3139

3124

3032

3106

3008

3009

329

323

376

3245

3327

3068

3070

3076

3253

5004

3311

3094

3095

3113

3139

3124

3032

3106

3008

3009

329

323

376

3245

3327

3068

3070

3076

3253

5004

3311

3094

3095

3113

3139

3124

3032

3106

3008

3009

329

323

376

3245

3327

3068

3070

3076

3253

5004

3311

3094

3095

3113

3139

3124

3032

3106

3008

3009

329

323

376

3245

3327

3068

3070

3076

3253

5004

3311

3094

3095

3113

3139

3124

3032

3106

3008

3009

329

323

376

3245

3327

3068

3070

3076

3253

5004

3311

3094

3095

3113

3139

3124

3032

3106

3008

3009

329

323

376

3245

3327

3068

3070

3076

3253

5004

3311

3094

3095

3113

3139

3124

3032

3106

3008

3009

329

323

376

3245

3327

3068

3070

3076

3253

5004

3311

3094

3095

3113

3139

3124

3032

3106

3008

3009

329

323

376

3245

3327

3068

3070

3076

3253

5004

3311

3094

3095

3113

3139

3124

3032

3106

3008

3009

329

323

376

3245

3327

3068

3070

3076

3253

5004

3311

3094

3095

3113

3139

3124

3032

3106

3008

3009

329

323

376

3245

3327

3068

3070

3076

3253

5004

3311

3094

3095

3113

3139

3124

3032

3106

3008

3009

329

323

376

3245

3327

3068

3070

3076

3253

5004

3311

3094

3095

3113

3139

3124

3032

3106

3008

3009

329

323

376

3245

3327

3068

3070

3076